

ORIGINAL
FILE COPY

PLANNED SIGN PROGRAM

FOR

NEW ARCO AM/PM FACILITY
S.E.C. VICTORIA AVE & W FIFTH STREET
OXNARD, CA 93030

CITY OF OXNARD

CITY COUNCIL

PLANNING COMMISSION

EXHIBIT "A"

Action: APPROVED

Resolution (Ord) No. 7743

Date: 8/4/94

9 JULY 1993

EDA

ENGINEERING
DEVELOPMENT
ASSOCIATES

1320 NIPOMO STREET □ SAN LUIS OBISPO, CA 93401 □ 805/549-8658

ARCO Products Company

Division of AtlanticRichfield Company

Real Estate . Site Acquisition

17315 Studebaker Road
Cerritos CA 90701-1488



SIGN STATISTICS TABLE

ALLOWABLE SIGNAGE: Commercial Zones (Sec. 34-186)

Maximum sign area: One sq. ft. of sign area for each lineal foot of lot frontage:
 1 s.f. x 220 lineal feet = 220 s.f.

Attached signs: 300 s.f.
 (50 s.f. each sign)

Maximum height: 24 ft.

PROPOSED SIGNAGE: Gasoline Station/Mini-market

SIGN #	TYPE OF SIGN	AREA (total)	FACE	REMARKS
				APPROVED BY MINOR MUD.
Sign "A"	Channel ^{CAN SIGN} Ltr. "am/pm" Sign	32 24 s.f.	Single	Exhibits "A" & "F"
Sign "B"	Monument Price Sign	4 s.f.	Double	Note 1, Exhibit "B"
Sign "B"	Monument Price Sign	4 s.f.	Double	Note 1, Exhibit "B"
Sign "D"	Spandrel Sign	36 s.f.	Double	Exhibits "D" & "F"
Sign "D"	Spandrel Sign	36 s.f.	Double	Exhibits "D" & "F"
Sign "E"	24 HOURS Sign	24 s.f.	Single	Exhibits "E" & "F"
Sign "E"	24 HOURS Sign	24 s.f.	Single	Exhibits "E" & "F"

SUMMARY: ALLOWABLE SIGNAGE = 220 s.f.
 PROPOSED SIGNAGE = ~~152~~ s.f.

232 sq. ft. (L. Windsor - approved by
 Plng Comm.
 8/4/94 Reso 7743
 240 p 60 11/16/99

Notes:

- The actual logo area of the monument sign is 4 s.f. per face. Gasoline price panels are required by law and are not included in the sign area calculation for the monument sign.

EDA

ENGINEERING
 DEVELOPMENT
 ASSOCIATES

1320 NIPOMO STREET • SAN LUIS OBISPO, CA 93401 • 805/549-8658

SIGN PLAN STATISTICS TABLE

All Signs are Internally Illuminated, plexiglass material

PROPOSED RANCHO VICTORIA PLAZA

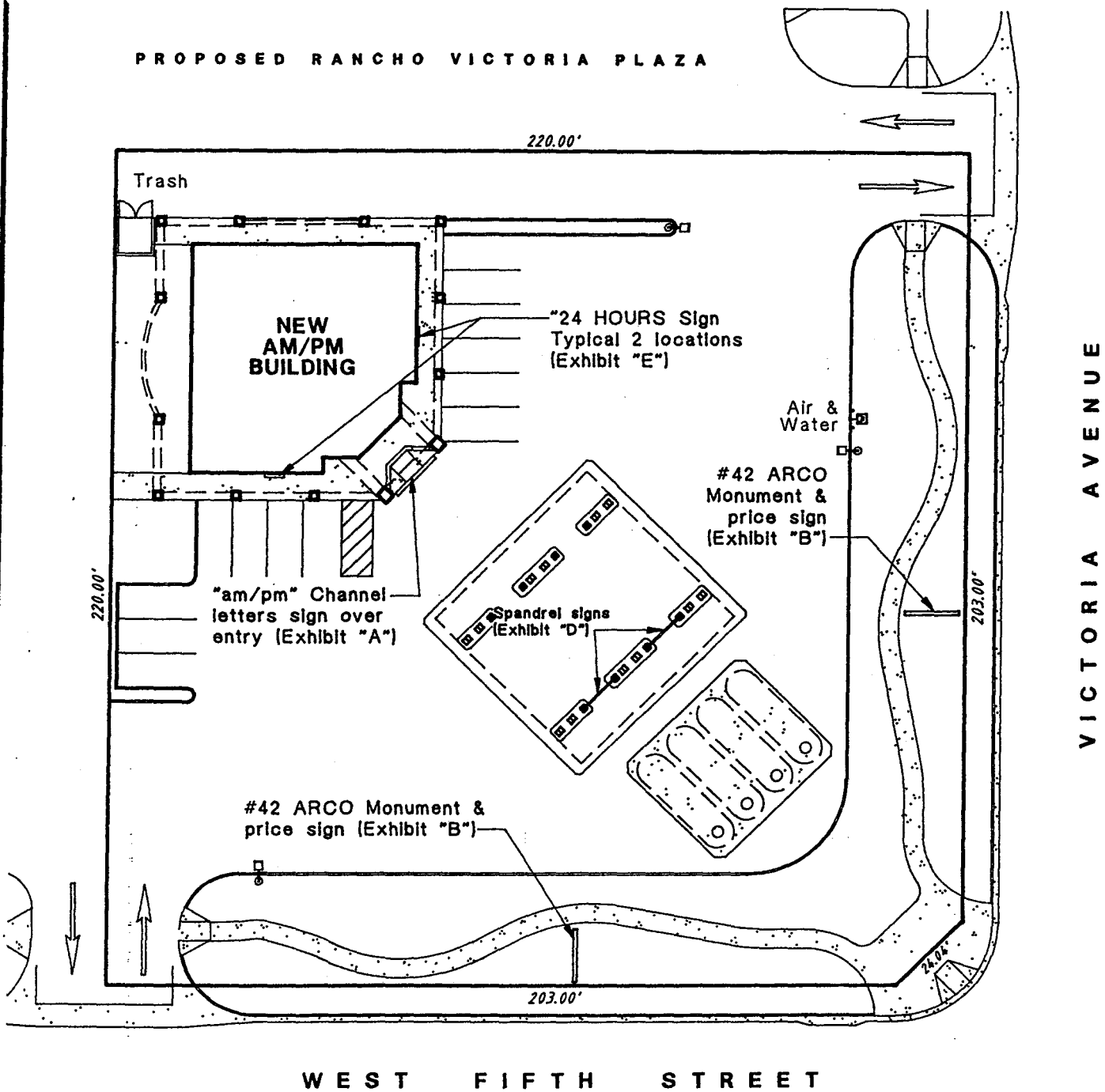

0 5 10 20 40 60



SCALE: 1" = 40'



NORTH

EDA

ENGINEERING
DEVELOPMENT
ASSOCIATES

1320 NIPOMO STREET □ SAN LUIS OBISPO, CA 93401 □ 805/549-8658

SITE PLAN
for
SIGN EXHIBITS

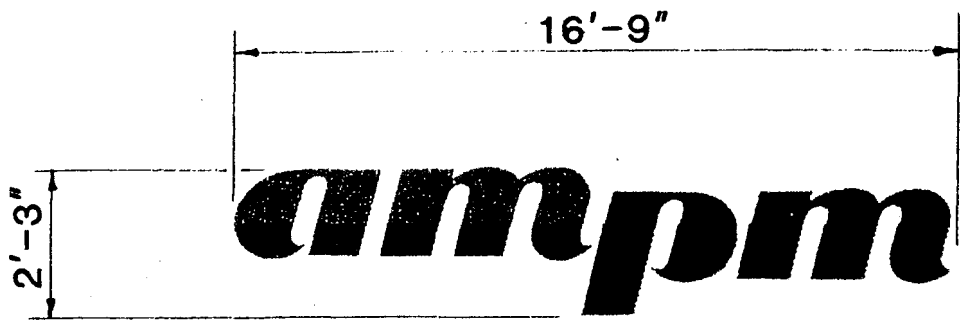

Total area: 24 s.f.

Exhibit "A"

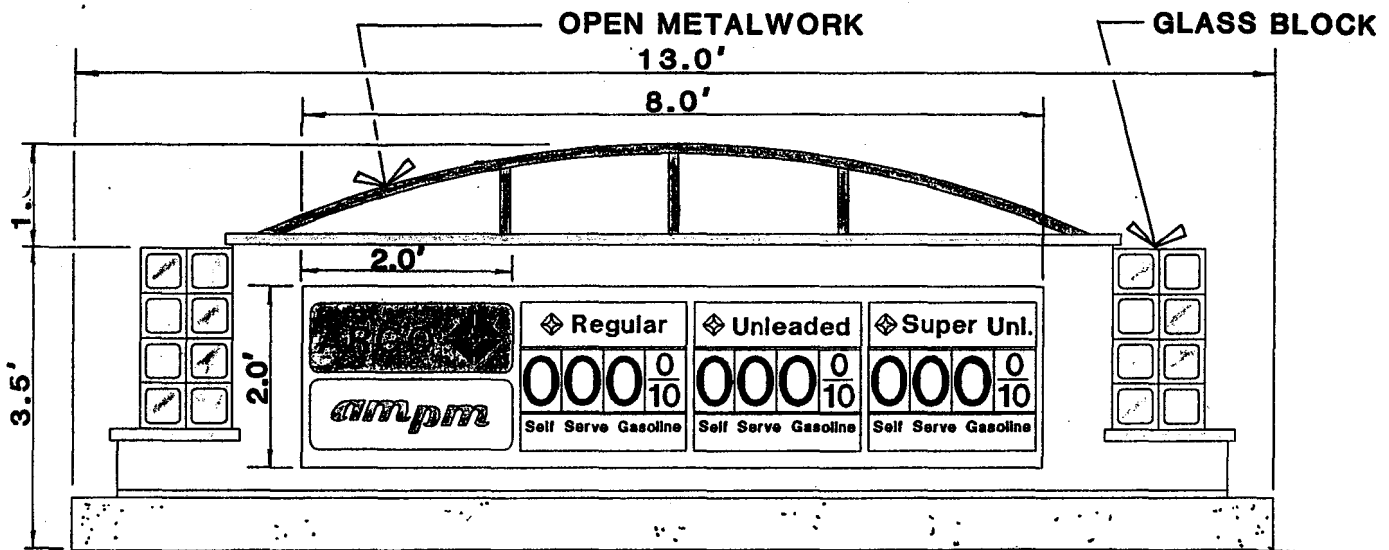

Monument

ARCO, am/pm, 3 price Combination
Monument Sign

Total area: 16 s.f.

Exhibit "B"

Logo area: 4 s.f. per face

EDA

ENGINEERING
DEVELOPMENT
ASSOCIATES

Exhibits
"A" & "B"

1320 NIPOMO STREET □ SAN LUIS OBISPO, CA 93401 □ 805/549-8658

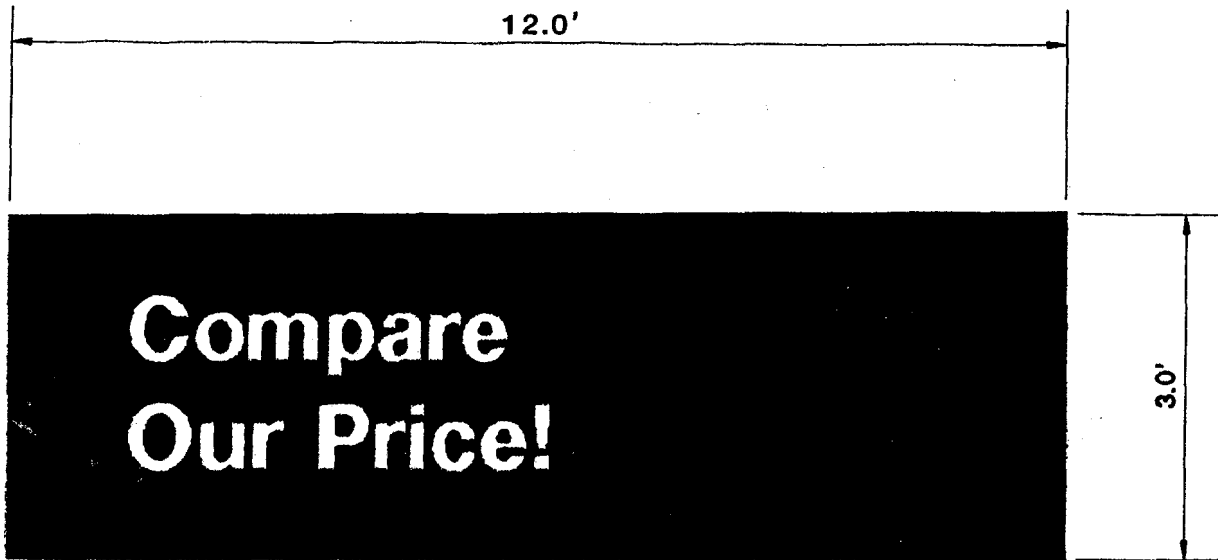

Total area: 36 s.f. per face

EDA

ENGINEERING
DEVELOPMENT
ASSOCIATES

Exhibit "D"

1320 NIPOMO STREET □ SAN LUIS OBISPO, CA 93401 □ 805/549-8658

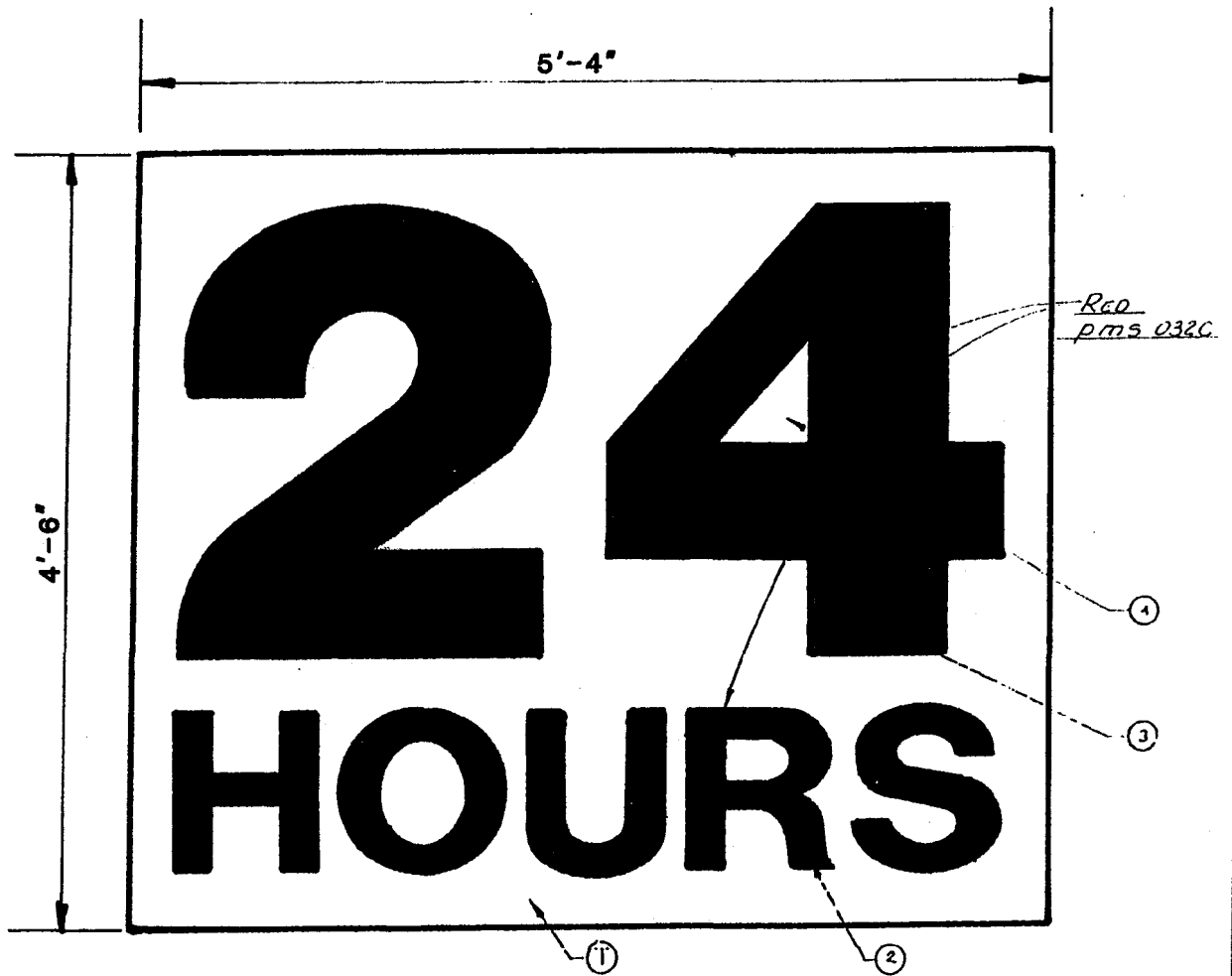

Total area: 24 s.f.

EDA

ENGINEERING
DEVELOPMENT
ASSOCIATES

1320 NIPOMO STREET ◻ SAN LUIS OBISPO, CA 93401 ◻ 805/549-8658

Exhibit "E"