

IMPORTANT INFORMATION

- * Accessory structures or buildings not meeting ALL exempt standards shall be subject to the full requirements of the Zoning and Building Codes.
- * For the purpose of this handout Accessory Structures and Accessory Buildings are the same and have the same requirements.
- * Accessory building shall not be occupied for living or sleeping purposes.
- * Accessory building shall not be served by any utilities.
- * Maximum extension of roof eaves shall not exceed twelve (12) inches.
- * Furniture, plants and similar items shall not be placed on or above any exempt structure.

ALLOWABLE LOCATION ON PROPERTY

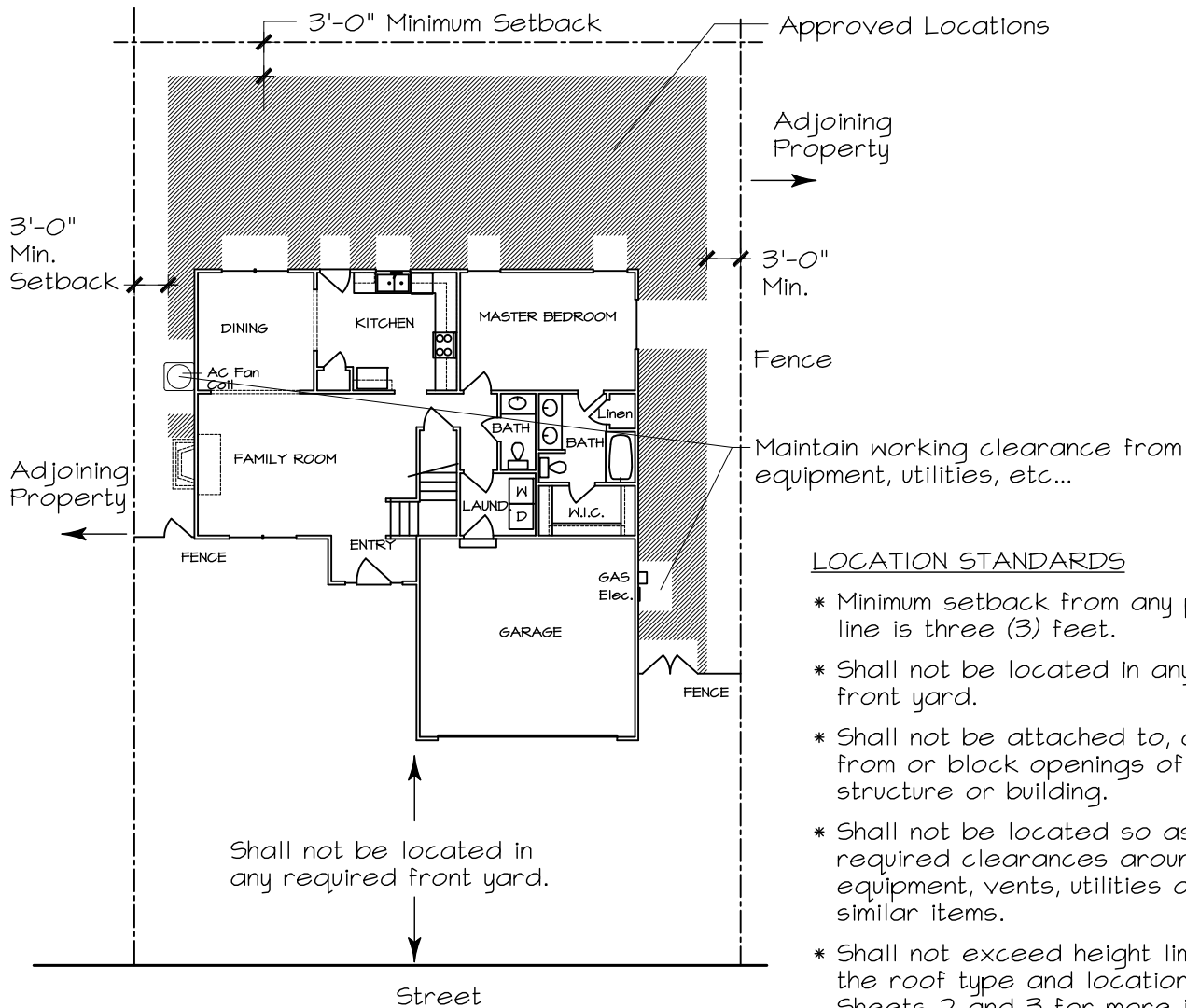

LOCATION STANDARDS

- * Minimum setback from any property line is three (3) feet.
- * Shall not be located in any required front yard.
- * Shall not be attached to, accessed from or block openings of any other structure or building.
- * Shall not be located so as to block required clearances around equipment, vents, utilities or similar items.
- * Shall not exceed height limits for the roof type and location. See Sheets 2 and 3 for more info.



EXEMPT ACCESSORY STRUCTURES

HELP FOR THE HOMEOWNER
DEVELOPMENT SERVICES

Steve Newman 3/25/15

Deputy Building Official: Date

Date: 3/10/15 Sheet 1 of 4 B200